

D-51

1

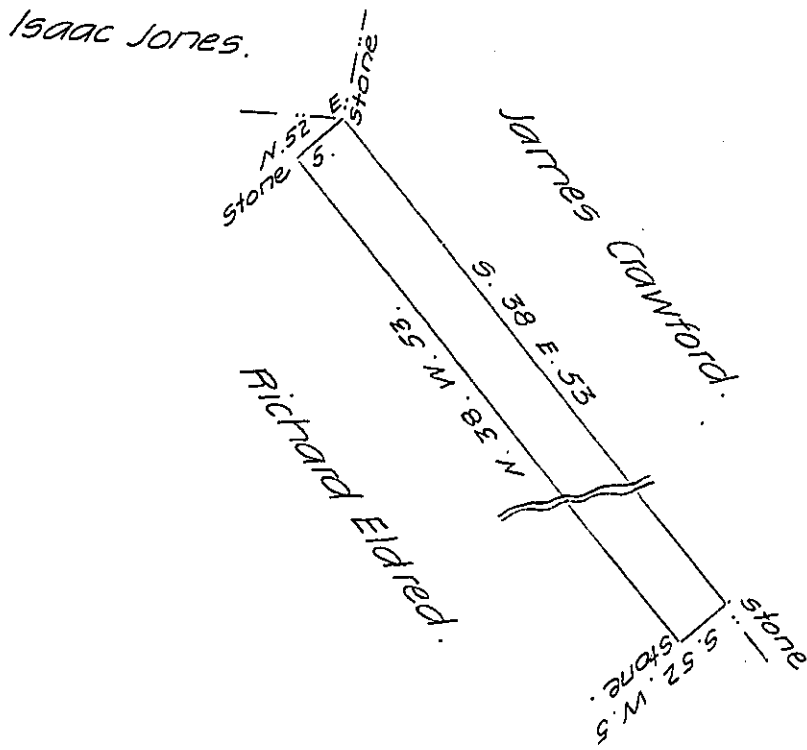

By virtue of a warrant dated the 16th of March, 1850. Surveyed the 21st of March 1850 to James Crawford the above described tract of land situate in Westfall township. Pike County adjoining other land of said Crawford on the North East and land of Richard Eldred on the southeast, south & south west (Including an improvement) Containing one acre and nine perches and the allowance of six per cent for Roads & Co. Pr.

John T. Cross D.S.

To John Laporte Esq  
Surveyor General of Penna.

IN TESTIMONY that the above is a copy of the original remaining on file in the Department of Internal Affairs of Pennsylvania, made conformably to an Act of Assembly approved the 16th day of February, 1833, I have hereunto set my Hand and caused the Seal of said Department to be affixed at Harrisburg, this sixteenth day of March 1908.

*Henry Houck*  
Secretary of Internal Affairs.